

Emergency Habitat Modules (continued)

Ease of Building

The group of Intershelter EHM's below were erected by people with limited carpentry skills in just a matter of hours providing secure housing in a day!



MILITARY MOBILE SUPPORT STRUCTURES

Description

The MMoSS will render the tent, a structure used in military campaigns for over 2000 years, obsolete. Our soldiers have decisive victories but lack short / medium term storage, medical and housing infrastructure without massive building and logistic support. With MMoSS, each semi truck trailer can hold 8 MMoSS units providing ballistic and environmental protection to 32 soldiers (3 squads). The MMoSS unit can withstand 6 direct hits with a .44 caliber round without penetration, thereby exceeding the Class 3 ballistic armor requirements. Additional protection is available as an option up to 7.62 NATO.



The natural spherical shape increases MMoSS survivability as projectiles will always impact a curved surface thereby causing an indirect impact and expending the kinetic energy prior to entry. In addition to storage and housing of troops, the MMoSS is ideal for Medical Services in both conventional and biological conflicts. Combined with the ballistic protection, the MMoSS units can easily be sealed environmentally and can utilize positive pressure HVAC systems with HEPA and Carbon scrubbing filters to ensure airborne contaminants are kept external to the structure.

MMoSS lends itself extremely well to triage and isolation requirements within the trauma units. They provide a secure, environmentally sealed structure whereas isolation or triage services can be accomplished closer to the battlelines with much more protection than the current fabric based systems in use today. Providing protection and stabilization as soon as possible is what MMoSS does the best.

CITY OF LOS ANGELES

CALIFORNIA



ANTONIO R. VILLARAIGOSA
MAYOR

As a 32-year career emergency manager we see few opportunities to really make giant leaps in the way we do things in disaster preparedness/ I believe InterShelter is one of those opportunities when we can do some things differently.

I look forward to sitting down and discussing future opportunities. Let's continue to try to make a difference and change to culture of preparedness and recovery.

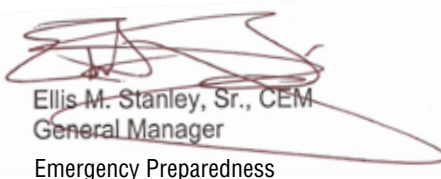
Ellis M. Stanley, Sr., CEM
General Manager
Emergency Preparedness

INTERSHELTER INC.

15945 Glacier Hwy.
Juneau, Alaska 99801
Phone: 907.789.9273
intershelter@aol.com

INTER SHELTER

Shelter

noun:

"a place giving temporary protection from bad weather or danger."

"a shielded or safe condition; protection or sanctuary"

Description

Intershelter Inc. designs and builds portable, stackable and rigid Emergency Habitat Modules (EHM's).

These EHM's, can be erected by unskilled labor in less than 2 hours and will provide 320 sq ft. of living space or about the size of 3 bedrooms or a studio apartment.

Portability

The EHM provides a studio apartment size living space shipped in a 4X4X8 container. With this size consideration, you can ship 32 EHM's covering 10,000 square feet of secure and protected living space on just one C-130 Hercules Aircraft. With a flight of 6 C-130's with a flying time of 1 hour (200 miles), you can provide shelter to 768 people with medium term housing every other hour or 9200 people housed every day!



Emergency Habitat Modules

Strength

With the classic spherical design and strength, the EHM is strong, stable and rated for a Class 4 Hurricane or an 8.5 Earthquake. Los Angeles has a medium term housing program in a troubled neighborhood. The EHM has been utilized as an interim step to permanent housing. Strength is not its only benefit, each piece weighs less than 70 pounds and is easily and safely transported by hand across uneven ground. ➡

www.intershelter.com



20 ft. Intershelter Specifications

Diameter.....20 ft
Height.....12 ft at center
Floor Area... 314 sq. ft/up to 500 sq. ft with loft
Door Opening
 36" x 81" (Standard)
Window Opening
 36" x 36" (Standard)
Weight.....1100 lb.
Price..... \$12,000
 FOB Spokane Washington

The Intershelter module in the above configuration can sleep 48 people in relative comfort. The center Intershelter structure of the module can be utilized as a bath/toilet facility / or common area. The entire Intershelter module including the 5 Intershelter will occupy less than 2500 square foot of space. We've created a response plan for emergencies utilizes the local high school football field as our location. We can place 23 of these Intershelter Modules (115 Intershelters) to house over 1000 persons on the playing field in comfort and security.

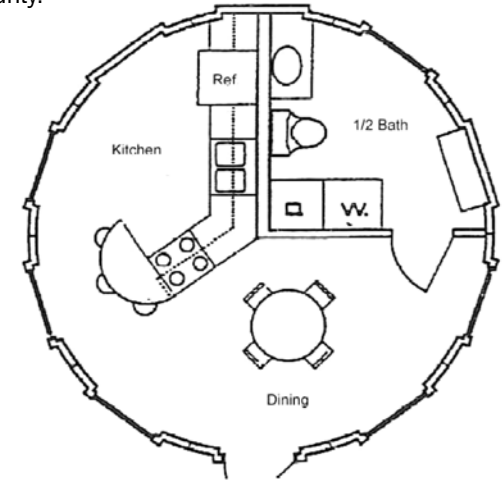

Intershelter Portable Housing

The Intershelter housing modules are portable, lightweight and even stronger than the original Omnisphere® designed by Craig Chamberlain. This new design incorporates the wisdom and accomplishments of Mr. Chamberlains career with the latest composite technology from the aerospace industry into a unit 25% less weight with increased strength and durability. Through our proprietary manufacturing process, we are able to reduce the Intershelter weight from 1500 pounds to under 1200 pounds!

The Intershelter dome provides options not afforded with today's current emergency or temporary shelters. Unlike tents or mobile structures, we can effectively seal the structure and provide a closed loop atmosphere with biological / HEPA filtration for both incoming and outgoing air. In a biological emergency, Intershelters can be configured to temporarily house persons from an overseas flight as a quick quarantine for those affected passengers/ crews. Intershelters staged at designated remote airports can be erected in just a few hours outside or within another structure like an aircraft hanger. These Intershelters would be effective in isolating persons suspected of H5N1 (Bird Flu), SARS, or other infectious diseases.

In addition to the reduction in weight, the Intershelter is made with structural fiberglass with fire resistant resins. The fire rating of the Intershelter exceeds FAA requirements for aviation by using these new materials, thereby offering protection that far exceeds tents or wooden temporary structures. As recent tragedies demonstrate, tents and wooden structures are not safe or reliable in extreme conditions.



Another plan we've developed is for the isolation and containment of persons suspected of infection by airborne pathogen who arrive into the US via aircraft. This plan would utilize an existing aircraft service hanger (200' x 100') to house 480 persons (an average 747-400 carries 420 passengers) within 40 Intershelters. These special Intershelter units have sealed seams and 3 through-wall ports for HEPA air filtration, electrical and exhaust air.

As ordered, the Intershelter continues to use standard size residential doors and windows for ease of installation and / or repair. These standard sizes are available at a myriad of hardware stores or lumber companies such as Home Depot® or Lowes®. Further, you can customize your Intershelter to your specific needs as construction techniques and parts are as ubiquitous as they are inexpensive. Assembly therefore, is very simple with hand-tools and 2 workers with few construction skills needed. Intershelters can be erected within 2 hours with 2 people.

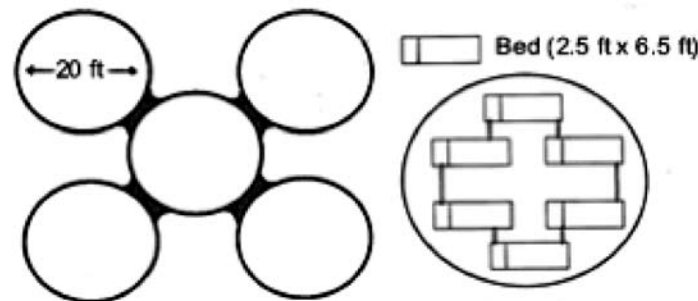

Our shelters are perfect for post Hurricane Katrina situations. Families can erect their own shelters, protect their belongings from looting, while comfortably staying on their own property as a family unit. After dealing with the stress of losing everything in a hurricane or earthquake the last thing they need is to be relocated or separated.

Our current production capability is entirely scaleable depending on demand or orders. We will ship from Spokane, Washington on rail, barge or truck. Delivery times to Seattle, Washington is 7 hours to the freight facility. From Seattle, shipping options include rail, truck, aircraft, and steamship.